

### User Guide

Wi-Fi On/Off Dual Controller

### Product Description

The Wi-Fi On/Off Dual Controller has 2\*5A capacity output and it works with traditional switches for dual or multiple control, allowing easy 2-way switching between a traditional and a kinetic switch.

It can be mounted in the ceiling, wall, electrical socket box, lamp panel. Using the Kinetic Switch APP it can be voice controlled with scene and timing control.

### Specifications

Product Code: ERC2202-W

Voltage range: 100-240V~ 50/60Hz

Working environment temperature: -20°C - 55°C

Control distance: 80m outdoor, 25m indoor

Capacity: Up to 10 switches can be paired with one controller

Control method: Wi-Fi through Device APP (search "Kinetic Switch" in store) and pairing with Wireless Switch (see instructions)

Product Size: L44\*W44\*H22mm

Communication Way: Wi-Fi IEEE 802.11 b/g/n 2.4G & RF 433MHz

Control Load: 2\*5A

Maximum Load: LED 500W

\*Distance comes from laboratory test results. The actual distance in practical use might vary due to environmental difference.

\*\*Maximum load rating may vary depending on manufacturers specifications.

### Terminals:

N: Neutral Input terminals

L: Live Input terminals

L1/L2: Live Output terminal

connected to light/load

S1/S2: Input terminal for traditional switch

(supports both push and rocker switch)

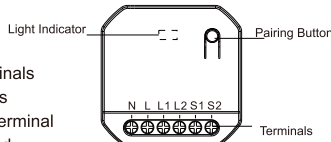

### Installation

1. The mini wireless receiver/controller line input should be connected using live and neutral cable from mains.
2. Output lines should be connected to load using cable rating suitable for 100-240V depending on voltage at site. (see diagram below).

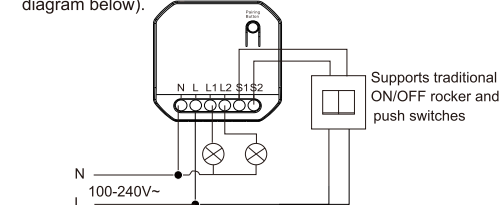

Controller supports automatic detection of wired switch type (rocker or push switch): After controller is powered on, press the wired switch once to set the wired switch type. To reset the wired switch type, power off the controller and then power on it again.

### Installation Locations

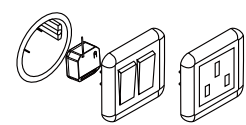

Mounted into the switch box or electrical socket

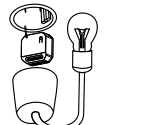

Mounted into the ceiling or the lamp panel

### Kinetic Switch APP Download:

The free Kinetic Switch App is required to operate your Wi-Fi controller. Ensure your iOS / Android device is connected to the internet using a Wi-Fi network.

Method 1:

1. Open the App store/Google Play on your phone.
2. Search for "Kinetic Switch" in the App store or Google Play.
3. Download the Kinetic Switch App to your phone.



Method 2:

Or you can download the app using the QR code below:



### Device Pairing with the APP:

The initial setup must be performed using your 2.4Ghz Wi-Fi network (5Ghz Wi-Fi is not supported). Both the phone and the controller must connect to your network.

1. After downloading the APP follow the prompts to register the account.
2. Turn on power to the controller and the red indicator light enters in fast flashing mode. If the light flashes differently or if you want to reset the controller press the pairing button for 10 seconds - the light will change from slow flashing to fast flashing to still. Release the button.

3. Open the "My Home" page of the Kinetic Switch App, and click "+" on the upper right of the page.
4. Click "Light Control", select "Wi-Fi Dual Controller (RF+Wi-Fi)", follow the instructions to operate it.
5. After successfully adding the receiver to the APP you can find the device in the "My Home" list. Lights can be controlled through the App from wherever in the world and smart scenes can be set.

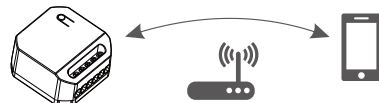

### Using Amazon Alexa/Google Home to control your Mini Wi-Fi Controller

Note: We would recommend naming the devices in your Kinetic Switch App something that is easy for Alexa or Google Home to understand. In order to integrate the Kinetic Switch app with Amazon Alexa/Google Home you need (see next page):

- 1) Amazon Alexa APP / Google Home APP
- 2) Amazon Alexa / Google Home account (users need to register their own account)
- 3) Echo, Echo Dot, Tap or other Amazon voice-operated devices.
- 4) Google Home, Google Home Mini or other Google voice-operated devices.

### Enable Smart Life skill/action in your Alexa / Google Home APP

Search for "Smart Life" skill and add it to the Alexa APP "Smart Home" skills. For Google Home search for "Smart Life" action and add it to Home Control. Enable the skill/action in your Alexa / Google APP and input the name and password used to register the Kinetic switch APP to link it with Alexa/Google APP.

Voice control can be used now to control the Wi fidevice such as: "Alexa/Ok Google, turn on/off [kitchen light]"

### Wi-Fi Controller Switch Pairing Method:

a controller can be operated by a maximum of 10 separate switches, a switch can pair an unlimited number of controllers.

### App Method

Enter the App page, click "Pairing" -> "Start Pairing". After the App page displays "waiting for pairing", press the corresponding button of the wireless switch that needs to be paired. This will complete the pairing. The App will prompt "Pairing succeeded" after the pairing is completed.

### Traditional Hardwired Switch Method

After the receiver is powered on (within 2 minutes), press the hardwired switch for 5 times (within 2 seconds). The light will start flashing, indicating pairing mode. At this time, press the wireless kinetic switch once and the light will stop flashing. The pairing is now completed. If the receiver is powered on for more than 2 minutes it cannot enter the pairing mode through traditional switch.

### Physical Wireless Switch Method

1. Press the function button for 3 seconds and the indicator light begins to flash slowly. Release the button to enter the single pairing state. (Fig.1)
2. Press the wireless kinetic energy switch and the indicator light of the controller will go out, which means that the pairing is successful. (Fig.2)

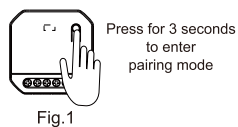

Fig.1

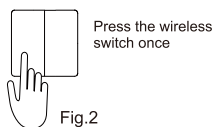

Fig.2

4. If you need to add more switches to the same controller please repeat the above process; each controller can store up to 10 switches, pairing in formation.
5. Single, dual and triple gang switches follow the same method.
6. The range of a switch may be extended by putting the controller in "Bridging Mode". In order to put the controller in bridging mode press the function button for 7 seconds until the red LED light changes from slow to fast flashing and release the button. The red LED will start flashing once every 2 seconds to indicate the successful bridging.
7. To disable the bridge mode, repeat the above steps.
8. If the controller indicator light continues to pulse the controller will still function normally even if used with a wireless switch.

### Clear Pairing Information:

#### App Method

Enter the App page, click "Pairing" -> "Clear Pairing", and select the corresponding channel. After the clearing is completed, App will prompt "Clearing Successful".

#### Physical button Method

To remove the controller stored pairing information press function button for 12 seconds until the indicator light goes out - the pairing information will be cleared.



Press the button for 12 seconds and the light will flash fast, then still and then it goes out.

### Precautions:

1. The wiring must be done in accordance with the method of installation illustrated.

2. Please note the maximum load of an individual controller. Exceeding this maximum will result in damaging the controller.
3. Do not short-circuit, it will cause permanent damage to the receiving controller.
4. The controller will remain "OFF" after a power cut, saving energy, reducing fire risk and protecting your appliances.
5. Damage caused by incorrect installation and operation are not covered under warranty.

### Troubleshooting:

1. If pairing does not work first check if the indicator is lit. Re-pair in case the pair is lost after power failure.
2. If the receiver does not respond check the LED indicator. If this does not light check the power supply.

### Pairing with the APP in AP Mode

The default configuration mode of the receiver is EZ mode(the light flashes quickly, twice per second). When pairing is not successful in EZ mode, you can enter the AP mode. The steps to switch to AP mode are as follows:

1. Press the button for 10 seconds in EZ mode, then release the button after the light is still, and it can switch to "AP mode"
2. In AP mode the light will flash slowly, turning off once every two seconds.
3. To switch from AP mode back to EZ mode, press the button for 10 seconds. The indicator light will flash quickly then still. When the light is still release the button.

Once the AP mode is activated open the "My Home" page of the Kinetic Switch App, and click "+" on the upper right of the page. Click "Light Control", select "Wi-Fi Dual Controller (RF+Wi-Fi)" and enter the Wi-Fi account password. On the next page tap "EZ Mode" on the upper right corner and select "AP Mode" from the drop down list. Follow the APP instructions to pair and operate the receiver.

Certificate / Inspected